

■ 铜镍对焊管帽 CAP  
DIN28011

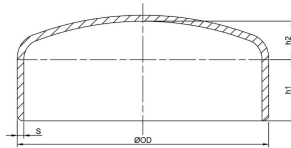

specification		OD	S	h1	h2	Weight
inch	DN	mm	mm	mm	mm	kg
1	25	30	1.5	14	5	0.07
1 1/4	32	38	1.5	14	6.5	0.10
1 1/2	40	44.5	1.5	14	8	0.12
2	50	57	1.5	18	10	0.18
2 1/2	65	76	2	18	16	0.31
3	80	89	2	20	16	0.39
4	100	108	2.5	20	20	0.75
5	125	133	2.5	20	24	0.95
6	150	159	2.5	20	29	1.35
7	175	194	3	20	36	1.95
8	200	219	3	20	41	2.60
10	250	267	3	20	50	3.85
12	300	324	4	20	61	6.60
14	350	368	4	20	69	8.80
16	400	419	4	20	79	12.20
18	450	457	4.5	20	87	12.55
20	500	508	5	20	96	18.80
24	600	610	5	20	115	26.70

■ 铜镍对焊管帽 CAP  
EEMUA 234

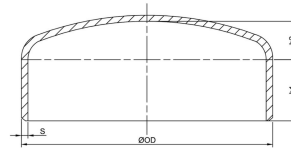

specification		OD	S 16bar	S 20bar	h1+h2 16bar	h1+h2 20bar	Weight 16bar	Weight 20bar
inch	mm	mm	mm	mm	mm	mm	kg	kg
1 1/2	44.5	2.5	2.5	19.6	19.6	0.08	0.08	
2	57	2.5	2.5	22	22	0.11	0.11	
2 1/2	76.1	2.5	2.5	25.7	25.7	0.18	0.18	
3	88.9	2.5	2.5	28.2	28.2	0.24	0.24	
4	108	3	3	31.7	31.7	0.40	0.40	
6	159	3	3.5	41	44	0.8	0.97	
8	219	4	4.5	55	60	2.0	2.40	
10	287	4.5	5.5	69	69	3.4	4.10	
12	323.9	5.5	7	80	85	5.9	7.70	
14	368	6.5	8	93	103	9.1	11.90	
16	419	7	9	102	112	12.4	16.90	
18	457.2	8	9.5	119	119	17.6	20.90	
20	508	8.5	11	129	139	22.7	30.80	
24	610	10.5	13	148	163	39.2	51.60	
28	711	12	15	178	191	61.8	81.40	
32	813	13.5	17	200	210	90.5	117.40	
36	914	15.5	19	221	231	132.2	166.20	